

DSi[®]

unique draught technologies

DISPENSE
SYSTEMS
INTERNATIONAL

BORA

BORA · BORA CONTROL

Secondary Reducing Valve



In line with the BLRA Code of Practice,
DIN 6650 and with SK-approval

**LEAVE YOUR OPTIONS
OPEN, BE FLEXIBLE**

BORA - THE FLEXIBLE SECONDARY REDUCING VALVE

- Upgradeable with thermo element via simple snap fit connection to BORA CONTROL (patented)

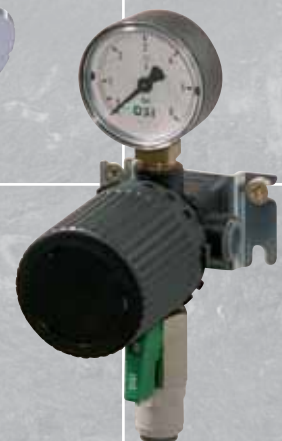
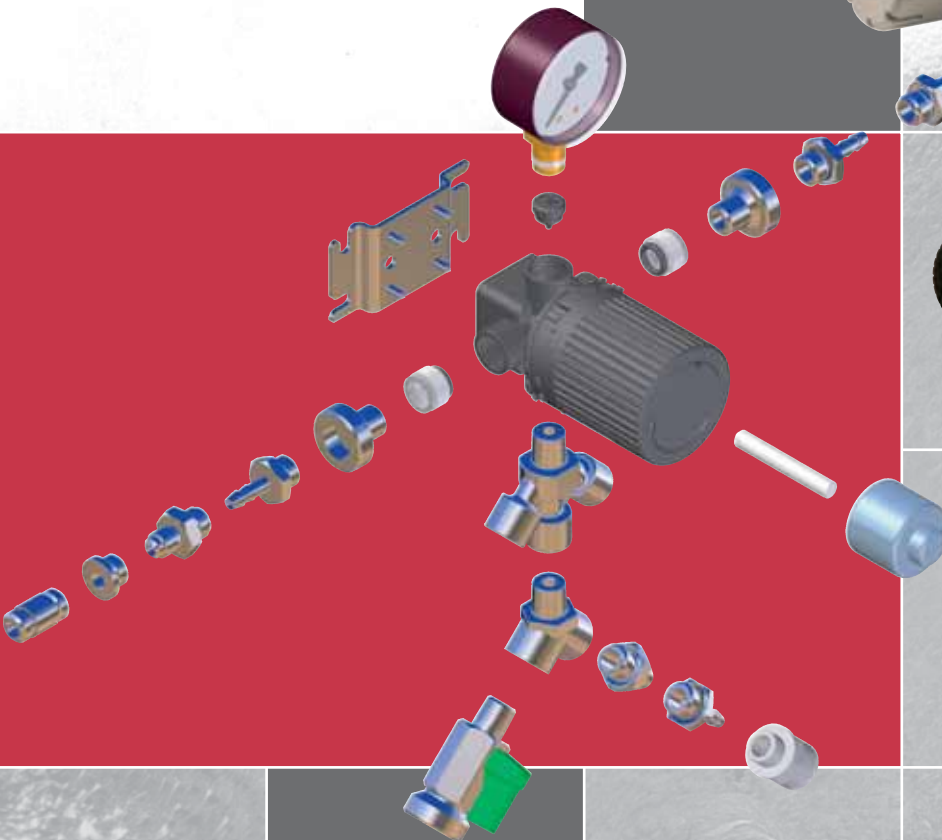

BORA

BORA · BORA CONTROL

Secondary Reducing Valve

- Very high flow capacity (needed as Bora control in combination with Mistral)
- Secondary vent/integrated relief valve

Flow chart with CO₂, P₁ = 3,5 bar

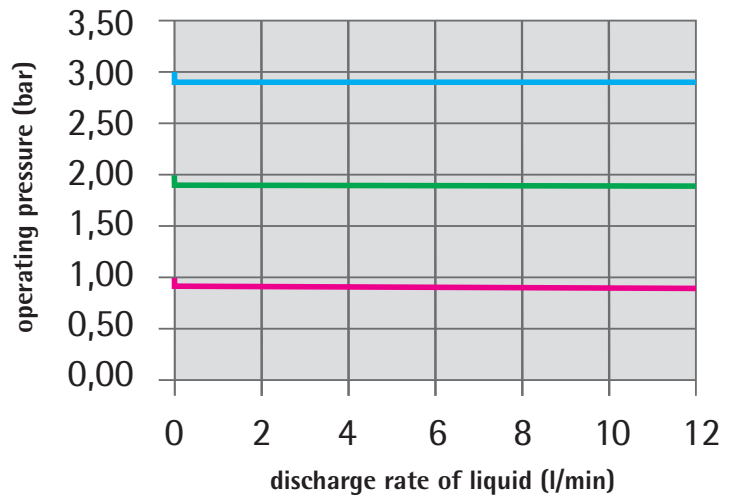

■ Simply the best

Setting range of BORA CONTROL

Beer

Curves of equilibrium pressure for beer with different CO₂ content in g/l

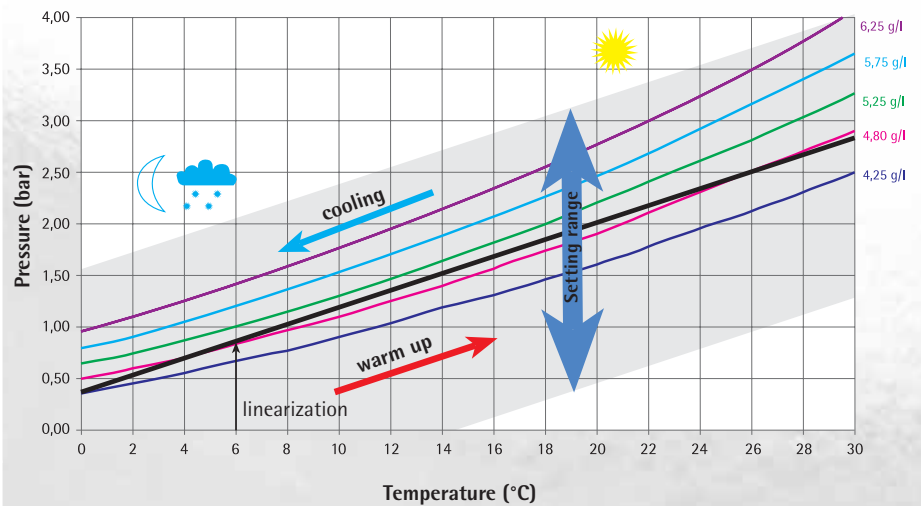

Setting range of BORA CONTROL

Softdrinks

Curves of equilibrium pressure for softdrinks with different CO₂ content in Vol

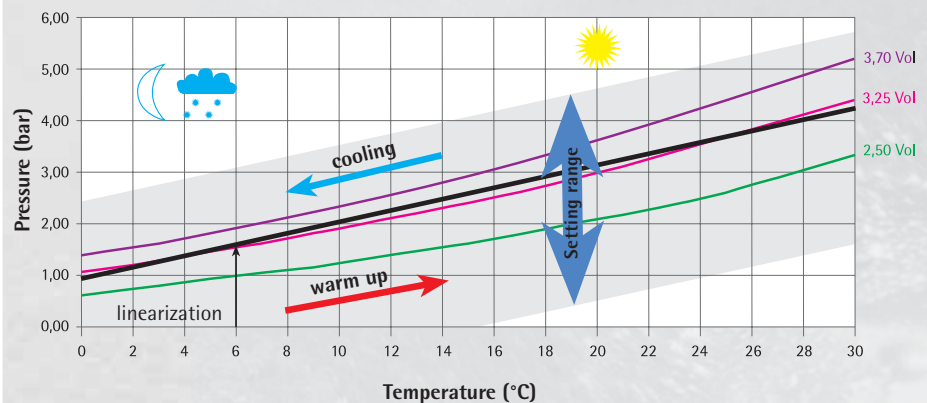

Without dispensing hysteresis of 0,25 bar during cooling

DSI[®]

unique draught technologies

DISPENSE
SYSTEMS
INTERNATIONAL



HEADQUARTER

DSI GROUP

Gewerbepark Hamm-Rhynern, Oberster Kamp 20,
59069 Hamm-Rhynern, Germany

Tel: +49 (0) 23 85-77 21 00, Fax: +49 (0) 23 85-77 22 49

E-mail: info@dsi-group.net, www.dispensegroup.com